

SUPPLEMENTARY AGENDA 2

Distributed on 5 November 2018



INNER WEST COUNCIL

LOCAL TRAFFIC COMMITTEE MEETING

TUESDAY 6 NOVEMBER 2018

10.00am

MEETING AGENDA – PRECIS SUPPLEMENTARY ITEMS

The following report/s appear as late item/s with approval as information required for the preparation of the report/s was not available at the time of distribution of the Business Paper.

Traffic Matters

ITEM	Page
LTC1118 Item 30 Gordon Lane, Petersham between Sadlier Crescent and Balanaming Lane – Temporary Full Road Closure (Stanmore Ward/Newtown Electorate/Inner West LAC)	3

Parking Matters

ITEM	Page
LTC1118 Item 31 Works Zone 7.00am-5.00pm Mon-Fri; 7.00am-1.00pm Sat - Applebee Street, St Peters (Marrickville Ward / Heffron Electorate / Inner West PAC)	8

Item No: LTC1118 Item 30

Subject: Gordon Lane, Petersham between Sadlier Crescent and Balanaming Lane – Temporary Full Road Closure (Stanmore Ward/Newtown Electorate/Inner West LAC)

Prepared By: Jennifer Adams - Engineer – Traffic and Parking Services

Authorised By: John Stephens - Traffic and Transport Services Manager

SUMMARY

An application has been received from Alert Traffic Control for the temporary full road closure of Gordon Lane, Petersham between Sadlier Crescent and Balanaming Lane, for a period of 10 hours on Thursday, 6 December 2018 between the hours of 7:00am and 5pm, in order to stand a mobile crane to carry out crane lift works. It is recommended that the proposed temporary full road closure be approved, subject to the conditions outlined in this report.

RECOMMENDATION

THAT the proposed temporary full road closure of Gordon Lane, Petersham between Sadlier Crescent and Balanaming Lane, for a period of 10 hours on Thursday, 6 December 2018 between the hours of 7:00am and 5pm, be APPROVED in order to stand a mobile crane to carry out crane lift works at No.22 Fisher Street, subject to the following conditions:

- a) A Road Occupancy License be obtained by the applicant from the Transport Management Centre;**
- b) All affected residents and businesses, including the NSW Police Local Area Commander, Fire & Rescue NSW and the NSW Ambulance Services be notified in writing, by the applicant, of the proposed temporary road closure at least 7 days in advance of the closure with the applicant making reasonable provision for stakeholders; and**
- c) The occupation of the road carriageway must not occur until the road has been physically closed.**

An application has been received from Alert Traffic Control for the temporary full road closure of Gordon Lane, Petersham between Sadlier Crescent and Balanaming Lane, for a period of 10 hours on Thursday, 6 December 2018 between the hours of 7:00am and 5pm, in order to stand a mobile crane to carry out crane lift works.

FINANCIAL IMPLICATIONS

The applicant is to pay a fee for the temporary full road closure in accordance with Council's Fees & Charges. This fee includes the cost of an advertisement which is a requirement under the Roads Act 1993.

OTHER STAFF COMMENTS

The Traffic Control Plan submitted by the applicant is shown below.

Vehicular access for local residents/businesses and emergency services will be maintained during the closure, where possible. Authorised Traffic controllers will be on-site during the time of the road closure and are to be positioned at the closure points when required to provide vehicular access to local residents/businesses and ensure the safety of motorists and pedestrians (refer to Traffic Control Plan and Traffic Management Plan below for details).

Locality map – Gordon Lane, Petersham

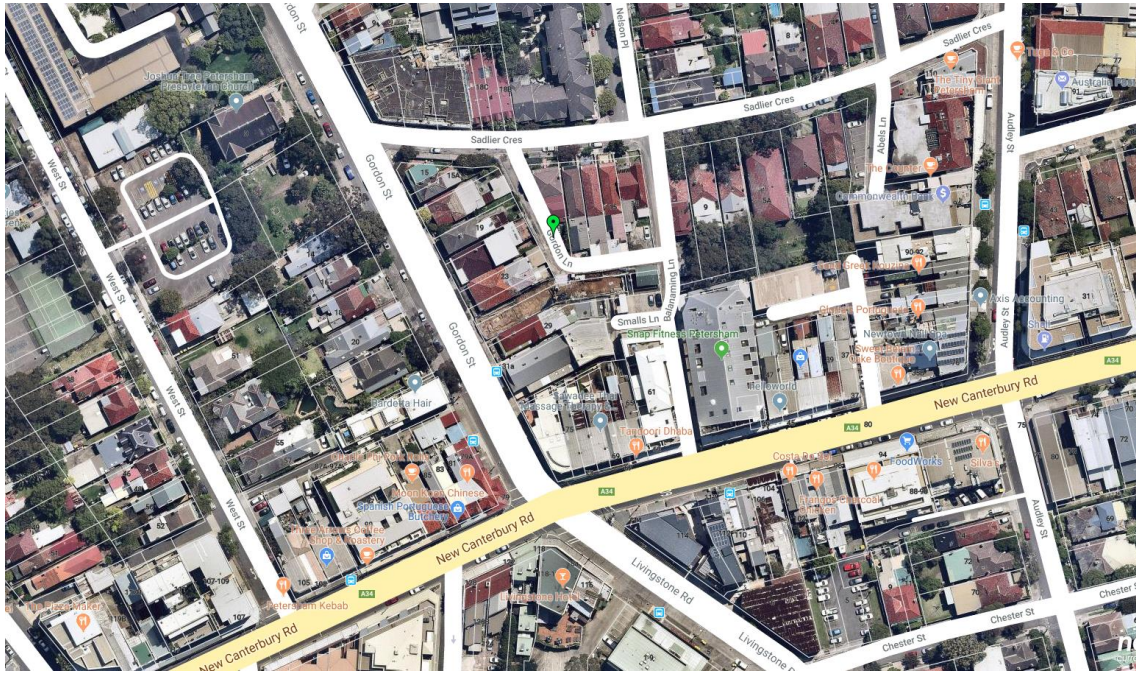

PUBLIC CONSULTATION

The applicant is to notify all affected residents and businesses in writing at least 28 days prior to the commencement of works.

The proposed road closure has been advertised in the local newspaper in accordance with the Roads Act 1993.

CONCLUSION

It is recommended that the proposed temporary road closures be approved, subject to the conditions outlined in this report.

Traffic Control Plan submitted by the applicant – 27 Gordon Street, Petersham

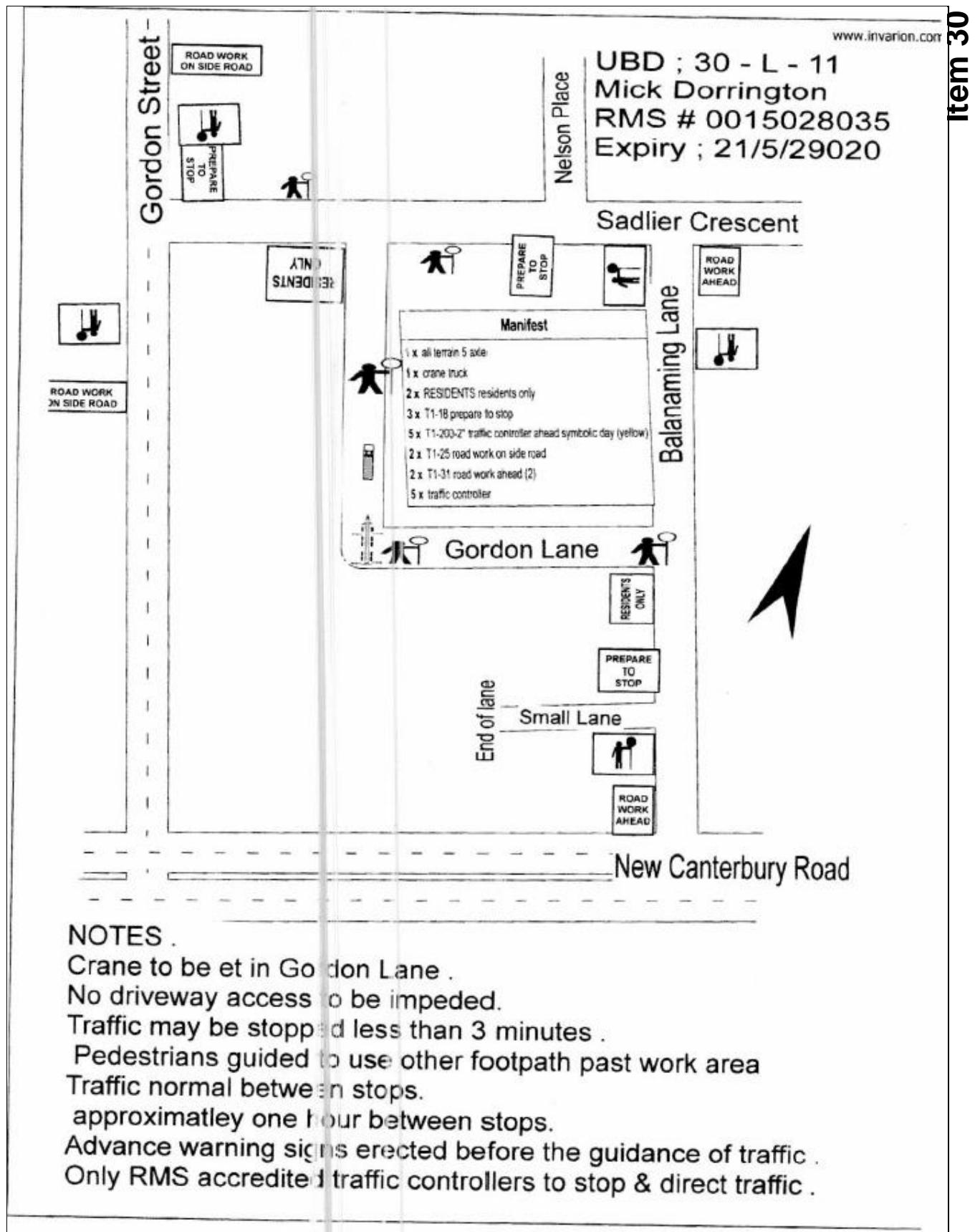

Traffic Management Plan submitted by the applicant – 27 Gordon Street, Petersham



ALERT

TRAFFIC CONTROL

PO Box 4171 Tregear NSW 2770

Mobile: 0423 661 607

Phone: 9864 0333

Fax: 9864 0433

TRAFFIC MANAGEMENT PLAN FOR THE CLOSURE OF GORDON LANE . PERTERSHAM .

Between Sadlier Crescent and Balanaming Lane .

Drawn by . Mick Dorrington . RMS # 0015028035 . Expiry ; 21/5/2020

Scope of works ;

Stand a 100 T crane in Gordon Lane to install a tower crane on # 27 Gordon Street.

Date ; Tuesday ; 4/12/18 .

Times ; 7am - 5pm

Traffic Management Plan Format .

A ; Description or detailed plan of proposed measures .

B ; Identification and assessment of impact of proposed measures .

C ; Measures to ameliorate the impact of re-assigned traffic .

D ; Assessment of public transport affected .

E ; Details of provisions made for emergency vehicles , heavy vehicles , cyclists and pedestrians .

F ; Assessment of effect on existing and future developments with transport implications in the vicinity of the proposed measures .

G ; Assessment of effect of proposed measures on traffic movements in adjoining Council areas .

H ; Public consultation process .

Traffic Management Plan for the closure of Gordon Lane . Petersham .

A ; Description or detailed plan of the proposed measures .

Alert Traffic Control proposes to close Gordon Lane . Petersham between Sadlier Crescent & Balanaming Lane on Tuesday 4/12/18 from 7am -5pm to stand a crane at the corner of the lane to install a tower crane on the site of #27 Gordon St . Traffic & pedestrians are to be stopped for trucks to reverse in from Sadlier St into position under the crane in Gordon Lane . RMS authorised traffic controllers will be on to preform this procedure . Traffic & pedestrians estimated to be stopped for less than 2 minutes for this procedure . Only 1 truck is to be Gordon Lane at any one time & parked away from site , to be called in when needed . No driveway access is to be impeded as trucks can be moved to accommodate residents entry & exits , Traffic controllers will be on site to assist . Advance warning signs are to erected before the guidance of traffic .

B ; Identification and assessment of impact of proposed measures .

Gordon Lane is a very localised lane with only local residents using it . Very little impact to residents with this closure , with the residents notified of the date & times of works & no driveway access is to be impeded .

C ; Measures to ameliorate the impact of proposed measures .

Advance warning signs are to be erected before the guidance of traffic . A letter box drop preformed to inform residents of date & times of works .

D ; Assessment of public transport affected .

NIL affect on public transport . Buses don't use Gordon Lane as a bus route . Buses will not to be stopped on approach . Taxis will be allowed entry into closed area under traffic control supervision.

E ; Details of provisions made for emergency vehicles , heavy vehicles , cyclists and pedestrians .

Emergency vehicles , residents & taxis will be allowed entry into the closed area under traffic controllers supervision . Emergency services to be advised of location , date & times of closure .

F ; Assessment of effect on existing and future developments with transport implications in the vicinity of the proposed measures .

NIL effect on future developments with this closure of Gordon Lane .

G ; Assessment of effect of proposed measures on traffic movements in adjoining Council Areas .

NIL effect on adjoining Council areas with this closure of Gordon Lane .

H ; Public consultation process .

A letter box drop is to be preformed for the residents of Gordon St , Sadlier St & Balanaming Lane to inform of the date , time & location of the closure of Gordon Lane .

Any Council condition to be implemented .

ATTACHMENTS

Nil.

Item No: LTC1118 Item 31

Subject: **Works Zone 7.00am-5.00pm Mon-Fri; 7.00am-1.00pm Sat - Applebee Street, St Peters (Marrickville Ward / Heffron Electorate / Inner West PAC)**

Prepared By: Manod Wickramasinghe - Coordinator – Traffic and Parking Services

Authorised By: John Stephens – Traffic and Transport Services Manager

SUMMARY

Council has received an updated application for the installation of a 30m 'Works Zone' in Applebee Street, St Peters.

RECOMMENDATION

THAT:

- 1. The installation of a 30m 'Works Zone 7.00am – 5.00pm Mon-Fri'; 7.00am - 1.00pm Sat" on the eastern side of Applebee Street adjacent to property Nos. 63-81 Princes Highway, St Peters be approved for 12 weeks; and**
- 2. The Works Zone is not to be used for the loading of trucks with demolished or excavated materials.**

BACKGROUND

Council has received an updated application for the installation of a 30m Works Zone on the eastern side of Applebee Street adjacent to property Nos.63-81 Princes Highway, St Peters in order to accommodate a truck and dog vehicle and other associated construction vehicles. A previous application was approved in August for a 12m Works Zone.

The approved Construction Traffic Management Plan (CTMP) indicates use of a typical truck and dog vehicle (19m long) to access the site.

The construction vehicles accessing Applebee Street will:

- Arrive at the site or the proposed works zones traveling from Princes Highway, May Street, Campbell Street, Hutchinson Street, Lackey Street, then turn left onto Applebee Street.
- Unload and load materials within the site boundary or from the proposed Works Zones.
- Depart from the site or the Works Zone on Applebee Street travelling along Applebee Street, turn right onto May Street, and then onto the Princes Highway.

A truck and dog vehicle has been tested out on site for the arrival route onto Applebee Street. The CTMP indicated that a truck and dog is able to access and depart the site via this route.

FINANCIAL IMPLICATIONS

Nil.

OTHER STAFF COMMENTS

In order to accommodate truck and dog vehicles to access the site, it is recommended that the proposed 30m 'Works Zone 7.00am – 5.00pm Mon-Fri; 7.00am - 1.00pm Sat' be installed on

the eastern side of Applebee Street adjacent to property Nos.63-81 Princes Highway, St Peters. The 'Works Zone' would be limited to the site frontage only.

PUBLIC CONSULTATION

Nil.

CONCLUSION

Nil.

ATTACHMENTS

Nil.